

MASTER OCÉAN chair

Simple and functional



This comfortable, functional chair has been designed to withstand intensive use.

Available in several different versions, this chair is suitable for the following uses:

- Retractable seating systems
- Fixed seats
- Beam-mounted moveable seats

The **ergonomic design, clean lines** and **spring-operated folding** seat mean this chair offers comfort and quality.

Each chair can be operated individually, using a quick, reliable mechanism located at the base of the metallic structure.



MASTER OCÉAN
Designed
and manufactured
entirely in France



* See terms and conditions
Warranty

FEATURES

For use as follows: Hinged foot for retractable seating systems (rear-mounted)/ Moveable (beam-mounted)/ Attached to the floor

Operation: Manual, pedal-operated

Attachment system:

- For retractable seating systems: 2 self-tapping screws on the structure + 4 hinge screws on the decking
- On the floor: pivots and screws suitable for the surface

Seat folding mechanism: Automatic (spring-operated)

The MASTER Océan chair complies with Article AM18 relating to the fire behaviour of upholstered chairs..

METAL FRAME

Tubular frame made using robot-assisted mechanical welding. Frame is made from laser-cut parts and machined axles for a precise finish

Protective coating: thermosetting paint. Standard colour: black (RAL 9005), other colours available, upon request

BACKREST/SEAT

Metal sleeves built into the backrest and seat, attached to the chair's metal frame

Wood frame made of beech plywood, 13 mm thick, shaped to fit the entire width

High-resilience, **high-comfort** cut polyurethane **foam**, density of 35 to 45kg/ M³, glued to the wooden frame

Ergonomic shape for maximum comfort

Removable fabric cover with zip

Double-stitched cover on the front of the backrest and the upper side of the seat cushion, for an elegant finish

Heat-sealed foam-backed fabric, 6 mm thick

ARMREST

Laser-cut and robot-assembled hinged metal frame

Manual operation

Arm pad made of upholstered foam or stained and varnished wood

OPTIONS

Choice of fabrics

Wooden casing behind the backrest and under the seat

Sheet metal casing behind backrest

Numbered seats



MASTER
INDUSTRIE



MASTER Océan FDG

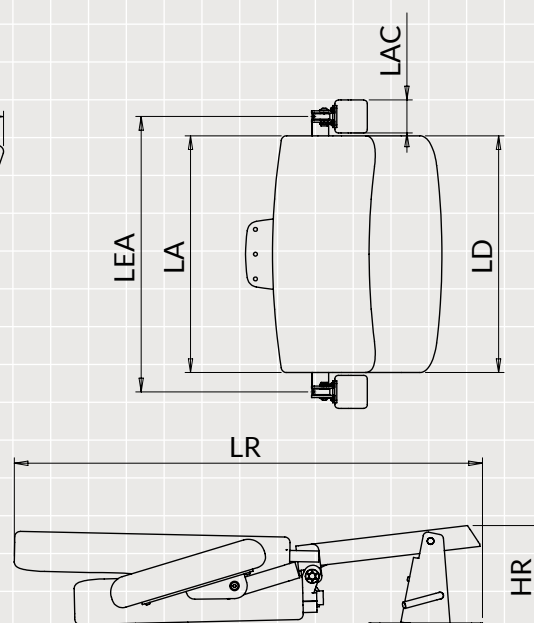
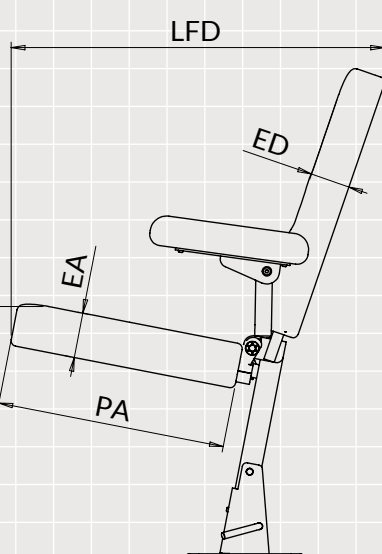
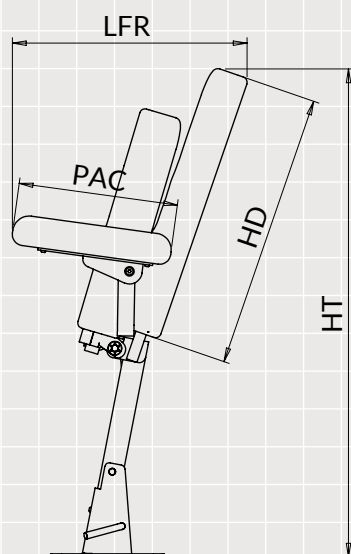

LEA	CENTRE TO CENTRE DISTANCE:	500 A 600 MM
LAC	ARMREST WIDTH:	60 MM
PAC	ARMREST DEPTH:	290 MM
LA	SEAT WIDTH:	430 A 530 MM
PA	SEAT DEPTH:	415 MM
EA	SEAT THICKNESS:	60 A 70 MM
LD	BACKREST WIDTH:	430 A 530 MM
HD	BACKREST HEIGHT:	450 A 520 MM

ED	BACKREST THICKNESS:	50 A 60 MM
HA	SEAT HEIGHT:	450 MM
HT	OVERALL HEIGHT:	840 A 905 MM
LFR	FOLDED UP DEPTH:	410 A 435 MM
LFD	OVERALL DEPTH:	660 A 685 MM
HR	FOLDED DOWN THICKNESS:	185 MM
LR	FOLDED DOWN LENGTH:	800 A 870 MM



Next generation retractable seating systems

MASTER INDUSTRIE Zone Vendéopôle - 1, rue René Laënnec - 85130 LA VERRIE
Tél. +33 (0)2 51 67 82 72 - Fax +33 (0)2 51 92 38 38 - e-mail : master@master-industrie.com - www.master-industrie.com

